

990 PAYNE AVE PROJECT

Saint Paul, Minnesota





CLIENT

LATINO ECONOMIC DEVELOPMENT FUND

C/O HENRY JIMENEZ
804 MARGARET STREET
SAINT PAUL, MN 55106

CONSULTING ARCHITECT

INFINITE GROUP LIMITED

275 MARKET STREET SUITE 519,
MINNEAPOLIS, MN
55405

#2 COCONUT AVENUE
ASYLUM DOWN
ACCRA GHANA

TEL: +233.541012471
TEL: +16122027417

CONTACT: MR KWADWO BOADI - PRINCIPAL/ ARCHITECTURE

TABLE OF CONTENTS

- 04: VISION/ PROGRAM
- 06: GOALS / PRECEDENTS
- 08: SITE ANALYSIS
- 14: CONCEPT PLANS
- 32: UNIT PLANS





A HISTORIC BUILDING

concept

The client (Latino Economic Development Center) has acquired a historic building previously occupied by burgeoning Latino business. The vision is to perpetuate the existing business, give the opportunity for new ones and also create a destination that embodies the principles of good quality life.

The development is to be a well planned multi purpose building. The main floor contains a barber shop, restaurants, retails and a great area for dining and socialization. The second floor contains meeting and office spaces. All the spaces to be designed considering the Latino community needs.



layout proposal



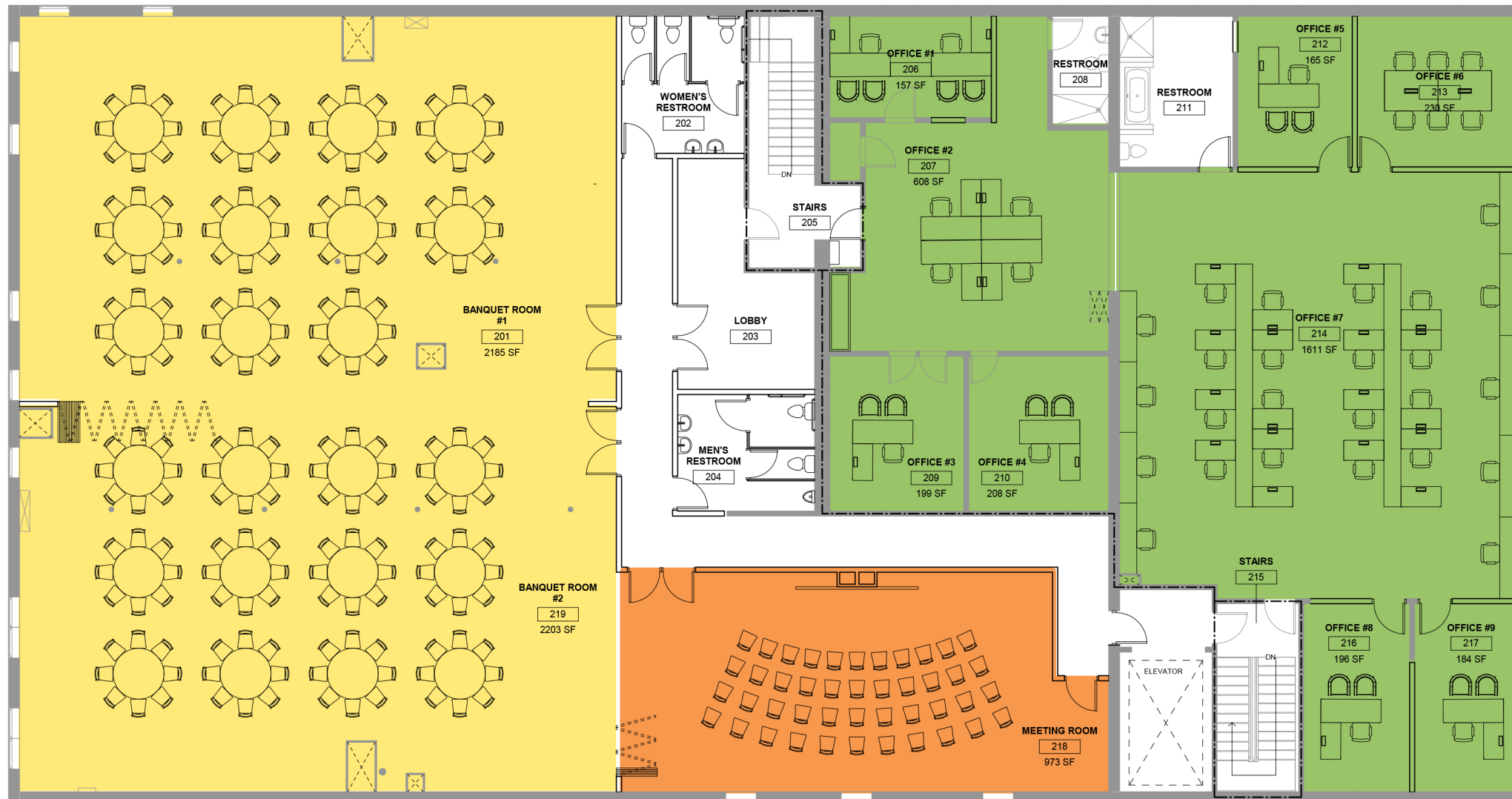

- BANQUET AREA
- MEETING ROOM
- OFFICE AREA

990 PAYNE AVE PROJECT - UPPER FLOOR LAYOUT PROPOSAL

precedents

FOOD HALL



FOOD HALL



OFFICE AREA



CLASSROOM/ MEETING ROOM



OFFICE AREA



BANQUET HALL



